

DONALD A. WEXLER ASSOCIATES
a r c h i t e c t u r e

October 20, 1998

Kenneth Neumann, FAIA, Chair
1999 Jury of Fellows
THE AMERICAN INSTITUTE OF ARCHITECTS
1735 New York Avenue, NW
Washington, D.C. 20006-5292

**Re: E. STEWART WILLIAMS
NOMINEE FOR FELLOWSHIP**

Dear Mr. Neumann:

Stewart Williams is an architect, an artist, an author, a photographer, a community leader, and a devoted family man. He is admired and respected by all members of our desert community not only for his professional achievements but for his honesty and integrity.

Throughout his career, Stewart maintained a small firm that accomplished a tremendous amount and variety of work. His projects covered the completed spectrum of design: from additions to housing to commercial work, from public and religious buildings to schools (elementary through college), county and city structures. Each completed project was unique, original and exceptionally well-designed.

As a friendly competitor and local architect living and working in the same community as Stewart, I have cherished my relationship with him over the past forty years. I admire his work tremendously and respect him both as a professional and as a man. It is my distinct pleasure to sponsor Stewart Williams in his nomination for a fellowship with the American Institute of Architects.

Very truly yours,

DONALD A. WEXLER ASSOCIATES

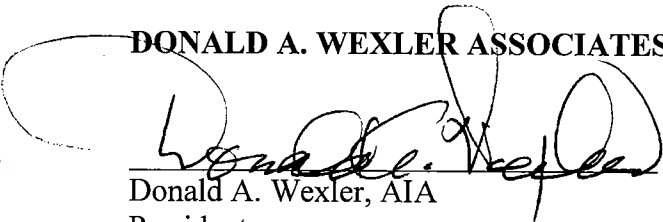

Donald A. Wexler, AIA
President

DAW:lk

Section 1: Summary

Nomination

E. STEWART WILLIAMS	
Nominee's name	
E. STEWART WILLIAMS, A.I.A., ARCHITECT	
Firm's name	
87 WESTLAKE CIRCLE, PALM SPRINGS, CA 92264	
Complete mailing address	
760/321-1198	(none)
Telephone number	Facsimile number
CALIFORNIA DESERT CHAPTER	1950
Nominee's assigned AIA chapter	Date nominee became AIA member

Category of Nomination: (select one box)

- To promote the aesthetic, scientific, and practical efficiency of the profession
 - design
 - urban design
 - preservation
- To advance the science and art of planning and building by advancing the standards of architectural education, training, and practice
 - education
 - research
 - literature
 - practice
- To coordinate the building industry and the profession of architecture
 - led the Institute
 - led a related professional organization
- To ensure the advancement of the living standards of people through their improved environment
 - public service work
 - government/industry organization
- To make the profession of ever-increasing service to society
 - alternative career
 - volunteer work

Sponsor

DONALD A. WEXLER, A.I.A.
Sponsor's name
199 S. CIVIC DRIVE, SUITE 10, PALM SPRINGS, CA 92262
Complete mailing address
760/320-1709
Telephone

Nominated by

Component Nomination
CALIFORNIA DESERT CHAPTER A.I.A.
Name of component organization

Signature, title of chapter president or secretary
JAMES R. CIOFFI, PRESIDENT
Typed name, title of chapter president or secretary
OCTOBER 14, 1998
Date

Section 1: Summary

E. STEWART WILLIAMS

Nominee's Education

(Chronological order/secondary education first/most recent last)

Name/location	Number of years	Degree
CORNELL UNIVERSITY, NEW YORK	5	B.A. in ARCHITECTURE
UNIVERSITY OF PENNSYLVANIA PHILADELPHIA	1	M.A. in ARCHITECTURE

Practice

State(s) or territory(ies) where nominee is licensed to practice architecture:

CALIFORNIA

Nominee is engaged in the profession of architecture as:

FIRM OWNER and DESIGNER

(example: firm owner, designer, educator, government architect, etc.)

Section 1: Summary

E. STEWART WILLIAMS

Stewart Williams is the quintessential architect and gentleman. His work has greatly enhanced our desert community and has served as a very positive influence on the regional architects and the community at large.

During Stewart's fifty-plus years of architectural practice, he has won many awards, including "Excellence in Design" for the Temple Isaiah in Palm Springs, the Coachella Valley Savings and Loan building, Santa Fe Federal Savings and Loan building, Crafton Hills College, Palm Springs Desert Museum and Dr. Erik Williams' Palm Springs residence. All of these awards were bestowed by various Southern California chapters of the AIA.

His designs are aesthetically superb and are in harmony with their surroundings and the desert environment.

His achievements during his academic years foreshadowed his outstanding professional career. As a student at Cornell University he received the Silver Medal from the AIA and he earned a fellowship at the University of Pennsylvania. Stewart then went on to serve his country during World War II as a member of the United States Navy.

Stewart Williams has been a member of the American Institute of Architects for almost fifty years; he served as president of the Inland District of the Southern California Chapter of the AIA.

Stewart served on numerous architectural and building commissions for the city of Palm Springs. The city passed a resolution: "*Honoring E. Stewart Williams for devoting countless hours of his time for the improvement of the community.*"

Stewart Williams' outstanding professional and community achievements are mirrored by his love and devotion to his family.

Section 3: Exhibits

Exhibit List

List below the exhibits, in order in which they appear, that are being submitted in support of this nomination. For design projects, include the location of the project. For all exhibits, list the year of completion/publication. Current work in support of the Object of nomination should be included.

1. E. Stewart and Mari Williams Residence, Palm Springs, CA, 1955 (Photo: Julius Shulman)
2. E. Stewart and Mari Williams Residence, Palm Springs, CA, 1955 (Photo: Julius Shulman)
3. William and Marjorie Edris Residence, Palm Springs, CA, 1955 (Photo: Julius Shulman)
4. Erik and Sidney Williams Residence, Palm Springs, CA, 1983 (Photo: E. Stewart Williams)
5. Palm Springs Aerial Tramway, Mountain Station, Mt. San Jacinto Park Authority, Palm Springs, CA, 1964 (Photo: Julius Shulman)
6. Santa Fe Federal Savings and Loan, Palm Springs, CA, 1967 (Photo: Julius Shulman)
7. Coachella Valley Savings and Loan, Palm Springs, CA, 1964 (Photo: Julius Shulman)
8. Crafton Hills College, San Bernardino Valley College District, Yucaipa, CA, 1966-69 (Photo: Julius Shulman)
9. Crafton Hills College, San Bernardino Valley College District, Yucaipa, CA, 1966-69 (Photo: Julius Shulman)
10. Crafton Hills College, San Bernardino Valley College District, Yucaipa, CA, 1966-69 (Photo: Julius Shulman)
11. Palm Springs Desert Museum, Palm Springs, CA, 1970-76, (Photo: Avra/Waggaman)
12. Palm Springs Desert Museum, Exterior View of South Garden, Palm Springs, CA, 1970-76 (Photo: Julius Shulman)
13. Palm Springs Desert Museum, Steve Chase Art Wing and Atrium, Palm Springs, CA, 1994-96 (Photo: David Glomb)
14. Palm Springs Desert Museum, Gallery Guide Floorplan

Section 2: Accomplishments

E. STEWART WILLIAMS

2.1 Significant Work

1946	FRANK SINATRA HOUSE	PALM SPRINGS
1947	THE COLONY FOR EARL CORDREY	PALM SPRINGS
1947	PALM SPRINGS HIGH SCHOOL GYM	PALM SPRINGS
1947	TEMPLE ISAIAH	PALM SPRINGS
1949	PALM SPRINGS BASEBALL & RODEO STADIUM	PALM SPRINGS
1950	DESERT HOSPITAL - 1 ST 30 BEDS (COLLAB.)	PALM SPRINGS
1950	FLORSHEIM SHOE SHOP	PALM SPRINGS
1951	RALPH KINER RESIDENCE	THUNDERBIRD
1952	H.J. BLIGH RESIDENCE	THUNDERBIRD
1953	WILLIAM EDRIS HOUSE	PALM SPRINGS
1955	LEON KOERNER HOUSE	PALM SPRINGS
1955	E.S. WILLIAMS (MARI & STEW) HOUSE	PALM SPRINGS
1956	PALM SPRINGS HIGH SCHOOL AUDITORIUM	PALM SPRINGS
1958	PALM SPRINGS HIGH SCHOOL LIBRARY BUILDING	PALM SPRINGS
1958	COLLEGE OF THE DESERT GYMNASIUM & POOL	PALM DESERT
1958	SUTTER RESIDENCE	PALM SPRINGS
1960	SANTA FE FEDERAL, PALM SPRINGS BRANCH	PALM SPRINGS
1963	CVSLA - NEW OFFICE BUILDING	PALM SPRINGS
1963	OASIS HOTEL FOR WESTERN HOTELS	PALM SPRINGS
1963	DESERT HOSPITAL ADDITION - 60 BEDS	PALM SPRINGS
1964	RIVERSIDE COUNTY ADMIN. & COURTS BUILDING	INDIO
1964	PALM SPRINGS AERIAL TRAMWAY INT. STATION	PALM SPRINGS
1965	OASIS BUILDING (OFFICE BLDG.) WESTERN HOTELS	PALM SPRINGS
1966	CRAFTON HILLS COLLEGE (COLLAB.)	REDLANDS/YUCAIPA
1966	PALM SPRINGS COLLABORATIVE PLAN FOR DOWNTOWN (COLLAB.)	PALM SPRINGS
1970	SANTA FE OFFICE BUILDING - 3 RD STREET	SAN BERNARDINO
1970	NEW PALM SPRINGS DESERT MUSEUM	PALM SPRINGS
1976	NEW MAIN OFFICE BUILDING - S.F.F. S.&L. - 8 TH ST.	SAN BERNARDINO
1976	PERFORMING ARTS CTR. & SCIENCE BLDGS. CRAFTON HILLS COLLEGE	REDLANDS/YUCAIPA
1979	ANNENBERG CENTER, EISENHOWER MED. CTR.	RANCHO MIRAGE
1983	HEART INSTITUTE OF THE DESERT	RANCHO MIRAGE
1986	ERIK WILLIAMS HOUSE (STEVENS RD.)	PALM SPRINGS
1990	ADRIAN GRAFF - RADFORD HOUSE	RANCHO MIRAGE
1994	STEVE CHASE ADDITION TO P.S. DESERT MUSEUM	PALM SPRINGS

Section 2: Accomplishments

E. STEWART WILLIAMS

2.1 Positions Held

- 1961 PRESIDENT OF THE INLAND DISTRICT, SOUTHERN CALIFORNIA CHAPTER OF THE AMERICAN INSTITUTE OF ARCHITECTS
- 1962 DESIGN CONSULTANT FOR GRADUATE STUDENT CENTER & FACULTY CLUB, UNIVERSITY OF BRITISH COLUMBIA
- 1963 MEMBER OF INTERNATIONAL JURY FOR THE ARCHITECTURAL COMPETITION FOR SIMON FRASER UNIVERSITY CONDUCTED BY THE ARCHITECTURAL INSTITUTE OF BRITISH COLUMBIA IN VANCOUVER, BRITISH COLUMBIA
- 1965- SPONSOR OF SOUTHERN CALIFORNIA REGIONAL PLANNING ASSOCIATION,
1966 MEMBER OF "SCOPE," THE AMERICAN INSTITUTE OF ARCHITECTS' SPECIAL COMMITTEE ON PROBLEMS OF ENVIRONMENT
- 1967 PRESIDENT OF THE PALM SPRINGS PLANNING COLLABORATIVE, A GROUP OF SEVEN ARCHITECTS COMMISSIONED BY THE CITY OF PALM SPRINGS TO PREPARE A COMPREHENSIVE REPORT AND DESIGN FOR THE REDEVELOPMENT OF THE CITY'S CENTRAL BUSINESS DISTRICT
- 1974 MEMBER OF THE DOWNTOWN DEVELOPMENT ADVISORY COMMISSION OF PALM SPRINGS AND CHAIRMAN, DESIGN MANUAL COMMITTEE FOR THE PALM SPRINGS CENTRAL BUSINESS DISTRICT

2.1 Architectural Firm Ownership

- 1946 – 1956 WILLIAMS, WILLIAMS & WILLIAMS
- 1957 – 1976 WILLIAMS & WILLIAMS
- 1978 – 1990 WILLIAMS, CLARK & WILLIAMS
- 1990 – Present E. STEWART WILLIAMS, A.I.A., ARCHITECT

2.1 Other Positions

- 1943 – 1946 SERVICE IN THE UNITED STATES NAVY, MARE ISLAND NAVAL YARD, SAN FRANCISCO, CALIFORNIA

Section 2: Accomplishments

E. STEWART WILLIAMS

2.2 Significant Awards

- 1933 SILVER MEDAL OF THE A.I.A. UPON GRADUATION FROM CORNELL UNIVERSITY
- 1934 THEOPHILUS PARSONS CHANDLER FELLOWSHIP – UNIVERSITY OF PENNSYLVANIA
- 1936 ZABRISKIE PRIZE, TOP PURCHASE AWARD OF THE AMERICAN WATER COLOR SOCIETY IN NEW YORK
- 1938 FINALIST IN GUGGENHEIM FELLOWSHIPS FOR RESEARCH IN MODERN ARCHITECTURE
- 1954 CERTIFICATE OF HONOR TO WILLIAMS & WILLIAMS FOR EXCELLENCE IN DESIGN OF THE TEMPLE ISAIAH, AWARDED BY SOUTHERN CALIFORNIA CHAPTER OF THE AMERICAN INSTITUTE OF ARCHITECTS
- 1961 DESIGN CONSULTANT FOR GRADUATE STUDENT CENTER & FACULTY CLUB, UNIVERSITY OF BRITISH COLUMBIA, AWARDED GOLD MEDAL OF RCIA
- 1966 AWARD OF HONOR TO WILLIAMS & WILLIAMS FOR CREATIVE USE OF CONCRETE ON THE COACHELLA VALLEY SAVINGS & LOAN BUILDING IN PALM SPRINGS, AWARDED BY THE PORTLAND CEMENT ASSOCIATION
- 1969 SPECIAL CITATION TO FIRM OF WILLIAMS & WILLIAMS FOR THE DESIGN OF THE SANTA FE FEDERAL SAVINGS & LOAN BUILDING IN PALM SPRINGS, AWARDED BY THE INLAND CALIFORNIA CHAPTER OF THE AMERICAN INSTITUTE OF ARCHITECTS
- 1973 FIRST AWARD OF EXCELLENCE AWARDED TO WILLIAMS CLARK & WILLIAMS FOR CRAFTON HILLS COLLEGE BY THE INLAND CALIFORNIA CHAPTER OF THE AMERICAN INSTITUTE OF ARCHITECTS
- 1974 RESOLUTION OF THE CITY COUNCIL OF PALMS SPRINGS, “HONORING E. STEWART WILLIAMS FOR DEVOTING COUNTLESS HOURS OF HIS TIME FOR THE IMPROVEMENT OF THE COMMUNITY” AS CHAIRMAN OF THE DOWNTOWN DEVELOPMENT ADVISORY COMMISSION
- 1978 SPECIAL AWARD OF EXCELLENCE TO WILLIAMS CLARK & WILLIAMS FOR DESIGN OF PALM SPRINGS DESERT MUSEUM, AWARDED BY INLAND CALIFORNIA CHAPTER, AMERICAN INSTITUTE OF ARCHITECTS.
- 1987 FIRST HONOR AWARD FOR HILLSIDE RESIDENCE OF DR. AND MRS. ERIK WILLIAMS IN PALM SPRINGS, AWARDED BY MASONRY INSTITUTE OF CALIFORNIA IN COMPETITION SPONSORED BY DESERT CHAPTER AMERICAN INSTITUTE OF ARCHITECTS.

Section 2: Accomplishments

E. STEWART WILLIAMS

2.3 List of Publications

1. Author E. STEWART WILLIAMS
Title PALM SPRINGS DESERT MUSEUM
Publication/ PALM SPRINGS DESERT MUSEUM
Publication Date 1979

2. Author DR. ING. CLAUDIO DI LUZIO
Title "CRAFTON HILLS COMMUNITY COLLEGE A REDLANDS –
YUCAIPA IN CALIFORNIA"
Publication/ L'INDUSTRIA ITALIANA DEL CEMENTO
Publication Date 1978

3. Author Not available
Title Not available. Article includes photo of Crafton Hills Community College
Project.
Publication/ ARCHITECTURAL RECORD
Publication Date 1977 or 1978

4. Author Not available.
Title Not available. Article includes photo of Stewart & Mari Williams Residence
in Palm Springs.
Publication/ ARCHITECTURAL RECORD
Publication Date 1957

Section 3: Exhibits

Descriptive Data

#1, 2 E. Stewart and Mari Williams Residence, Palm Springs, CA

Architecture Firm of Record Williams, Williams & Williams

Design Firm Williams, Williams & Williams

Completion date 1955

Role of Nominee Design Architect

Synopsis

Designed for the architect's family of five, the E. Stewart and Mari Williams house was conceived as an integral element of its site. The mild climate of Palm Springs allows for easy access between interior and exterior spaces. The low-pitched roof appears to hover above the glazed wall planes. The interior of the single story house is characterized by its open floor plan. A geometric order is established by the tilt-slab concrete panels and exposed wood frame. Built-in cabinetry defines functional areas without obstructing the spatial flow of this "post war" house.

Awards received:

Publications:

Declaration of Responsibility

I have personal knowledge of the nominee's responsibility for the project listed above. That responsibility included:

- Largely responsible for design
- Project under direction of nominee
- Nominee's firm executed project
- Other: Explain

Signature: *Julius Shulman Hon. A. I. A.*

Title/typed name: Julius Shulman, photographer

THE AMERICAN INSTITUTE OF ARCHITECTS ARCHIVES. For information or study purposes only. Not to be recycled, quoted, or published without written permission from the AIA Archives, 1735 New York Ave. NW, Washington, DC 20006



THE AMERICAN INSTITUTE OF ARCHITECTS ARCHIVES For information or study purposes only. Not to be recycled, quoted, or published without written permission from the AIA Archives, 1735 New York Ave. NW, Washington, DC 20006



Section 3: Exhibits

Descriptive Data

#3 William and Marjorie Edris Residence, Palm Springs, CA

Architecture Firm of Record Williams, Williams & Williams

Design Firm Williams, Williams & Williams

Completion date 1955

Role of Nominee Design Architect

Synopsis

In his design of the William and Marjorie Edris residence, Williams established a play between the random, massive rock formations found on the building site and the simple geometry of a house built for a couple. The slightly pitched shed roof (hung over three parallel beams) and a massive stone fireplace visually anchor the house to its dramatic site, while the glazed walls dissolve the separation between interior and exterior. Below, a circular pool extends the living space to the outdoors. Internally, built-in cabinetry defines the open floor plan into functional areas but also leaves the vistas from the house unobstructed.

Awards received:

Publications:

Declaration of Responsibility

I have personal knowledge of the nominee's responsibility for the project listed above. That responsibility included:

- Largely responsible for design
- Project under direction of nominee
- Nominee's firm executed project
- Other: Explain

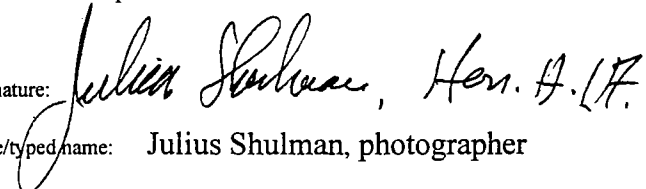
Signature:  *Julius Shulman, Hon. A. I. A.*

Title/typed name: Julius Shulman, photographer

THE AMERICAN INSTITUTE OF ARCHITECTS ARCHIVES For information or study purposes only. Not to be recycled, quoted, or published without written permission from the AIA Archives, 1735 New York Ave. NW, Washington, DC 20006



Section 3: Exhibits

Descriptive Data

#4 Erik and Sidney Williams Residence, Palm Springs, CA

Architecture Firm of Record Williams, Clark & Williams

Design Firm Williams, Clark & Williams

Completion date 1983

Role of Nominee Design Architect

Synopsis

This award-winning house was designed for the architect's eldest son and his family. Williams contrasts the color and texture of ribbed concrete blocks with the physical properties of the large boulders found on the site. A post-and-beam system using concrete piers and seen externally is continued within the house. Rather than define interior spaces with built-in furnishings as Williams had done with earlier houses, in this dwelling the architect introduces shifts of level to differentiate the core living space from other functional areas.

Awards received: First Honor Award from the Masonry Institute of California in a competition sponsored by the California Desert Chapter, A.I.A.

Publications:

Declaration of Responsibility

I have personal knowledge of the nominee's responsibility for the project listed above. That responsibility included:

- Largely responsible for design
- Project under direction of nominee
- Nominee's firm executed project
- Other: Explain

Signature:

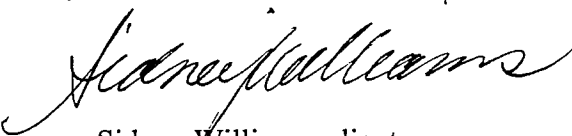

Title/typed name: Sidney Williams, client

THE AMERICAN INSTITUTE OF ARCHITECTS ARCHIVES For information or study purposes only. Not to be recycled, quoted, or published without written permission from the AIA Archives, 1735 New York Ave. NW, Washington, DC 20006

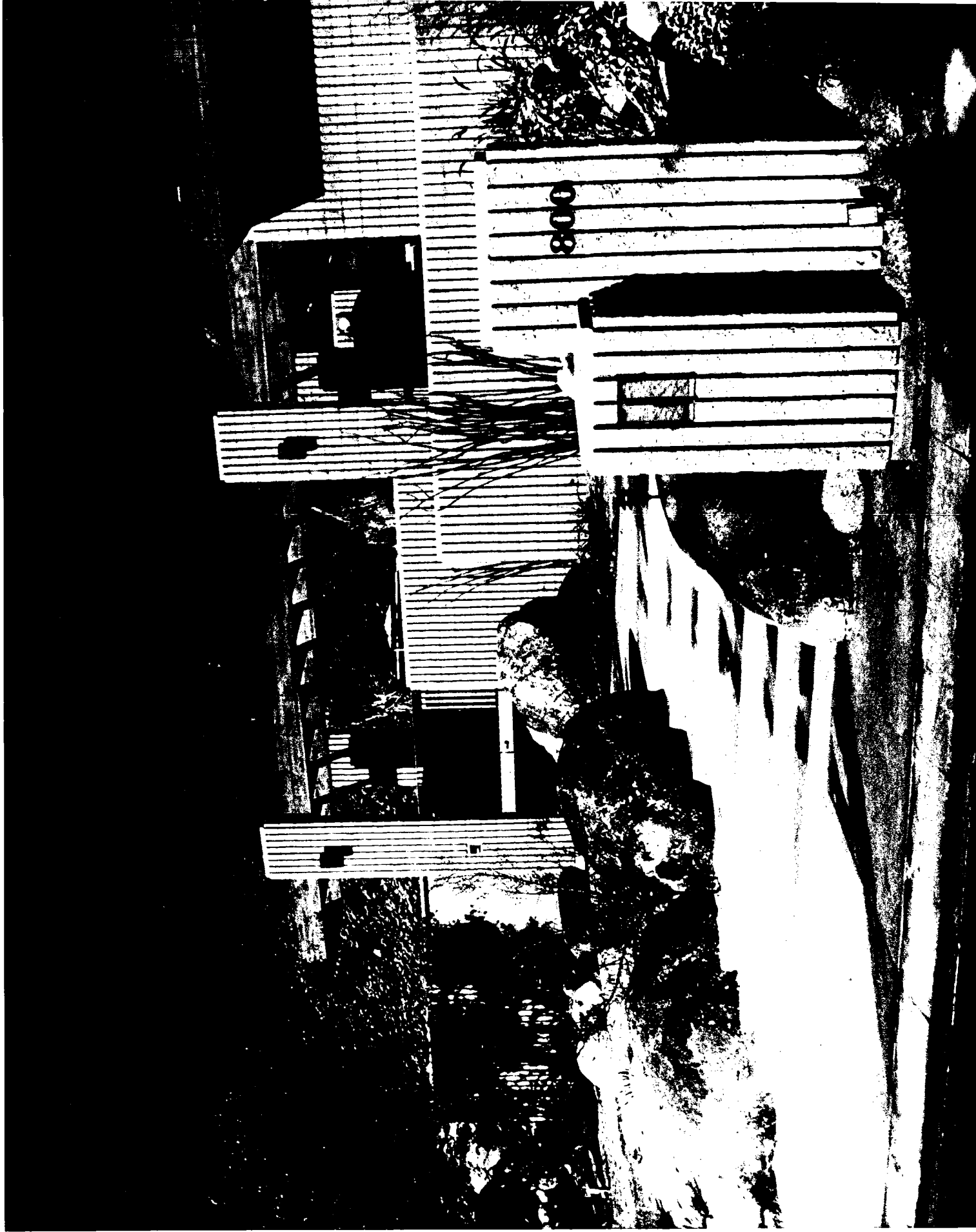

THE AMERICAN INSTITUTE OF ARCHITECTS ARCHIVES For information or study purposes only. Not to be recycled, quoted, or published without written permission from the AIA Archives, 1735 New York Ave. NW, Washington, DC 20006

Section 3: Exhibits

Descriptive Data

#5 Palm Springs Aerial Tramway, Mountain Station, Mt. San Jacinto Park Authority, Palm Springs, CA

Architecture Firm of Record Williams & Williams

Design Firm Williams & Williams

Completion date 1964

Role of Nominee Design Architect

Synopsis

Mt. San Jacinto rises 10,804 feet above the desert valley of Palm Springs. As an architect whose projects begin with environmental considerations, this defining feature of the Palm Springs landscape has consistently played a role in the development of Williams' projects. However, his response was never more direct than in the design for the Mountain Station of the Palm Springs Aerial Tramway, located 8,516 feet up the side of the mountain. The rigors of the site and the requirements of the State Park system were among the constraints that Williams addressed creatively in this alpine building.

Awards received:

Publications:

Declaration of Responsibility

I have personal knowledge of the nominee's responsibility for the project listed above. That responsibility included:

- Largely responsible for design
- Project under direction of nominee
- Nominee's firm executed project
- Other: Explain

Signature:

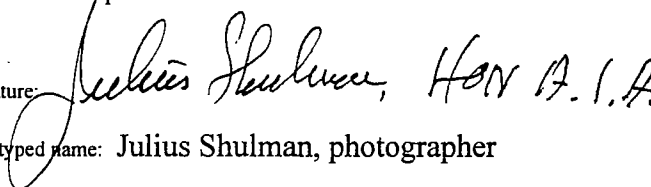

Title/typed name: Julius Shulman, photographer

THE AMERICAN INSTITUTE OF ARCHITECTS ARCHIVES For information or study purposes only. Not to be recycled,
quoted, or published without written permission from the AIA Archives, 1735 New York Ave. NW, Washington, DC 20006



THE AMERICAN INSTITUTE OF ARCHITECTS ARCHIVES For information or study purposes only. Not to be recycled, quoted, or published without written permission from the AIA Archives, 1735 New York Ave. NW, Washington, DC 20006

Section 3: Exhibits

Descriptive Data

#6 Santa Fe Federal Savings and Loan, Palm Springs, CA

Architecture Firm of Record Williams & Williams

Design Firm Williams & Williams

Completion date 1967

Role of Nominee Design Architect

Synopsis

This modest-sized savings and loan building contributed to the emerging urban character of Palm Springs in the 1960s. Located across the street from Coachella Valley Savings and Loan, the two buildings helped define the modest financial center for Palm Springs along Palm Canyon Blvd—the city’s main street. Operable aluminum screens, which can be adjusted depending on the orientation of the sun, introduce a jewel-like quality to this building.

Awards received: Special Citation for Design awarded by the Inland California Chapter, A.I.A.

Publications:

Declaration of Responsibility

I have personal knowledge of the nominee’s responsibility for the project listed above. That responsibility included:

- Largely responsible for design
- Project under direction of nominee
- Nominee’s firm executed project
- Other: Explain

Signature: *Julius Shulman, Hon. A.I.A.*

Title/typed name: Julius Shulman, photographer

THE AMERICAN INSTITUTE OF ARCHITECTS ARCHIVES For information or study purposes only. Not to be recycled, quoted, or published without written permission from the AIA Archives, 1735 New York Ave. NW, Washington, DC 20006



THE AMERICAN INSTITUTE OF ARCHITECTS ARCHIVES For information or study purposes only. Not to be recycled, quoted, or published without written permission from the AIA Archives, 1735 New York Ave. NW, Washington, DC 20006

Section 3: Exhibits

Descriptive Data

#7 Coachella Valley Savings and Loan, Palm Springs, CA

Architecture Firm of Record Williams & Williams

Design Firm Williams & Williams

Completion date 1964

Role of Nominee Design Architect

Synopsis

The building presents a modern, yet timeless quality—attributes associated with an updated classical image utilized in the design of public and commercial buildings during the late 1950s and 60s. The series of pre-cast inverted “T” beams span the raised platform of the building and roof. The exterior walls are sheathed in grooved aluminum siding.

Awards received: Award of Honor for Creative Use of Concrete awarded by the Portland Cement Association

Publications:

Declaration of Responsibility

I have personal knowledge of the nominee’s responsibility for the project listed above. That responsibility included:

- Largely responsible for design
- Project under direction of nominee
- Nominee’s firm executed project
- Other: Explain

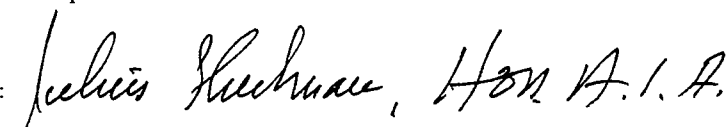
Signature:  Hon. A. I. A.

Title/typed name: Julius Shulman, photographer

THE AMERICAN INSTITUTE OF ARCHITECTS ARCHIVES For information or study purposes only. Not to be recycled, quoted, or published without written permission from the AIA Archives, 1735 New York Ave. NW, Washington, DC 20006



THE AMERICAN INSTITUTE OF ARCHITECTS ARCHIVES. For information or study purposes only. Not to be recycled, quoted, or published without written permission from the AIA Archives, 1735 New York Ave. NW, Washington, DC 20006

Section 3: Exhibits

Descriptive Data

#8, 9, 10 Crafton Hills College, San Bernardino Valley College District, Yucaipa, CA

Architecture Firm of Record Williams, Clark & Williams with Jones, Poper and Armstrong, Associated Architects

Design Firm Williams & Williams

Completion date 1966-69

Role of Nominee Design Architect of the campus plan and Design Architect of the buildings constructed in its first phase of development

Synopsis

The campus is located on a difficult site, characterized by narrow ridges and steep arroyos. Building sites were along the ridges; since there was no area for walkways, the buildings had to be raised above their sites to allow for foot traffic. Based on an academic cluster concept with individual student-faculty-classroom centers, the initial phase of construction consisted of a Laboratory Center, Library/Communications Center and a Classroom Center. Reinforced concrete, sandblasted with integral color, was selected as the primary building material for its fire-resistant properties. The large, sculptural quality of the buildings reflects Williams' mastery of concrete, his preferred construction material.

Awards received: First Award of Excellence from the Inland California Chapter, A.I.A.

Publications: Dr. Ing. Claudio DiLuzio, "Crafton Hills Community College a Redlands-Yucaipa in California," L'Industria Italiana Del Cemento, 1978.

Declaration of Responsibility

I have personal knowledge of the nominee's responsibility for the project listed above. That responsibility included:

- Largely responsible for design
- Project under direction of nominee
- Nominee's firm executed project
- Other: Explain

Signature:

Julius Shulman, HON. A.I.A.

Title/typed name: Julius Shulman, photographer

THE AMERICAN INSTITUTE OF ARCHITECTS ARCHIVES For information or study purposes only. Not to be recycled, quoted, or published without written permission from the AIA Archives, 1735 New York Ave. NW, Washington, DC 20006



THE AMERICAN INSTITUTE OF ARCHITECTS ARCHIVES For information or study purposes only. Not to be recycled, quoted, or published without written permission from the AIA Archives, 1735 New York Ave. NW, Washington, DC 20006

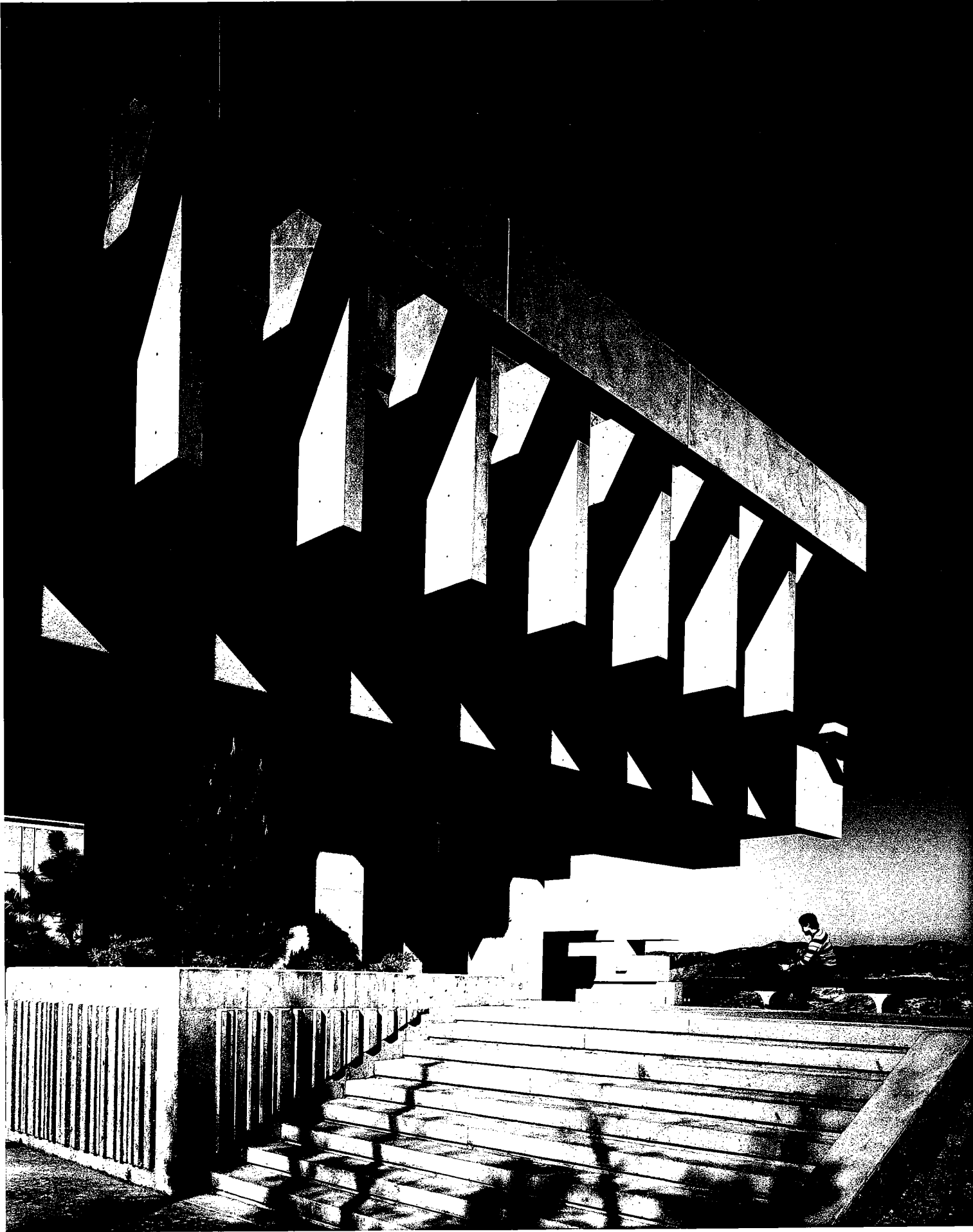

THE AMERICAN INSTITUTE OF ARCHITECTS ARCHIVES For information or study purposes only. Not to be recycled,
quoted, or published without written permission from the AIA Archives, 1735 New York Ave. NW, Washington, DC 20006



Section 3: Exhibits

Descriptive Data

#11, 12, 13, 14 Palm Springs Desert Museum, Palm Springs, CA

Architecture Firm of Record Williams, Clark & Williams, 1970-76; E. Stewart Williams, A.I.A., Architect, 1994-96

Design Firm same as above

Completion date original building: 1976; Steve Chase Art Wing and Education Center, 1996

Role of Nominee Design Architect

Synopsis

The three-part program of the museum assigned areas to serve the visual arts, natural science and performing arts. Williams' design solution to this unusual concept was to set two square-in-plan wings, accommodating art and natural science at 45° from the sculpture court and galleries, and to showcase performances in the Annenberg Theater on the lower level. Volcanic rock covers the projecting wings—selected for its light weight and warm-brown color; from the street, these appear to float above the below-grade sculpture gardens. The Steve Chase Wing includes an atrium (covering the former sculpture court), surrounding galleries for the permanent collection, and an education center.

Awards received: Special Award of Excellence from the Inland California Chapter, A.I.A.

Publications: E. Stewart Williams, Palm Springs Desert Museum, Palm Springs Desert Museum, Palm Springs, CA, 1979.

Declaration of Responsibility

I have personal knowledge of the nominee's responsibility for the project listed above. That responsibility included:

- Largely responsible for design
- Project under direction of nominee
- Nominee's firm executed project
- Other: Explain

Signature: 

Title/typed name: Janice Lyle, Ph.D., Executive Director, PSDM

THE AMERICAN INSTITUTE OF ARCHITECTS ARCHIVES For information or study purposes only. Not to be recycled, quoted, or published without written permission from the AIA Archives, 1735 New York Ave. NW, Washington, DC 20006



THE AMERICAN INSTITUTE OF ARCHITECTS ARCHIVES For information or study purposes only. Not to be recycled,
quoted, or published without written permission from the AIA Archives, 1735 New York Ave. NW, Washington, DC 20006

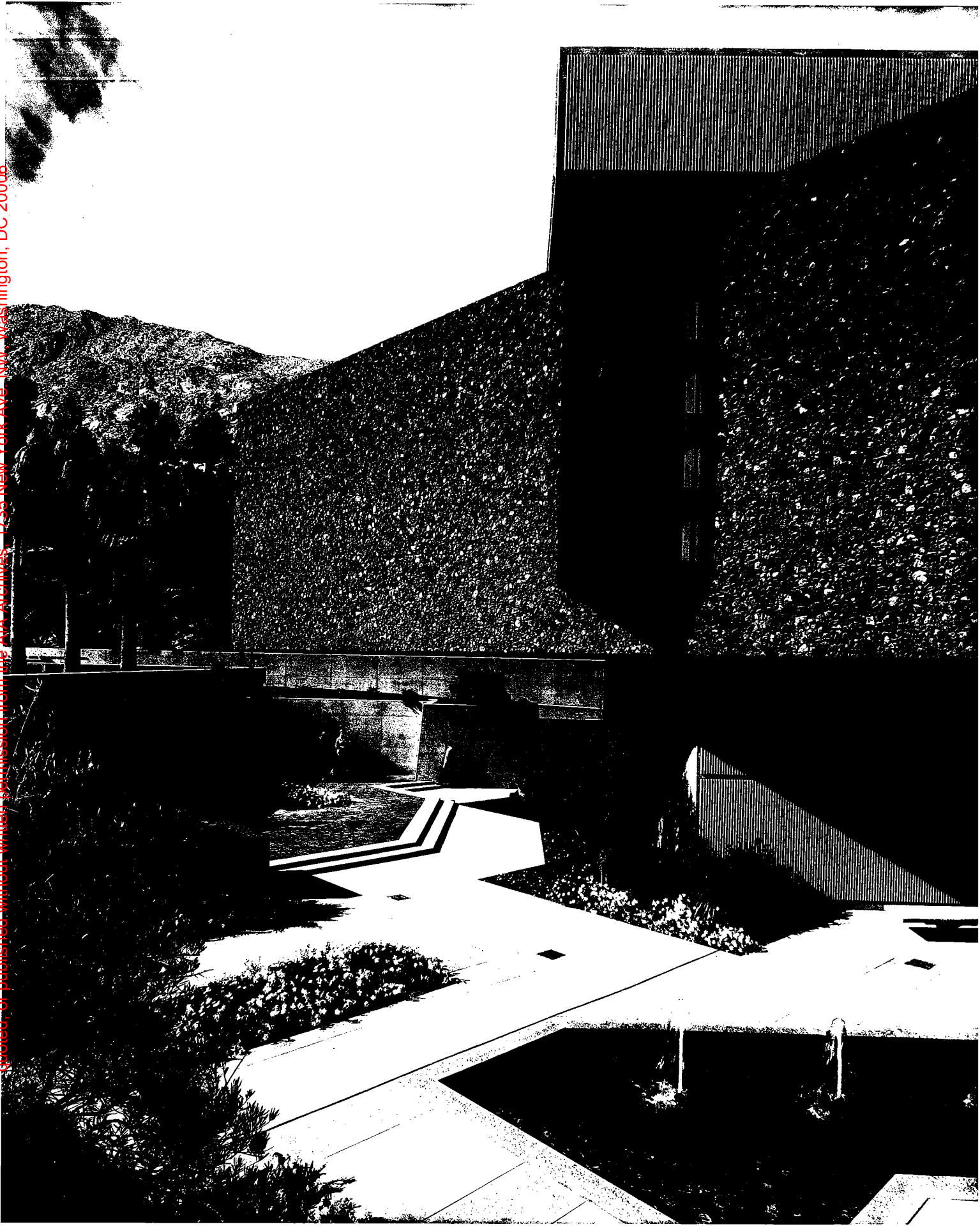

THE AMERICAN INSTITUTE OF ARCHITECTS ARCHIVES For information or study purposes only. Not to be recycled,
quoted, or published without written permission from the AIA Archives, 1735 New York Ave. NW, Washington, DC 20006



Upper Level

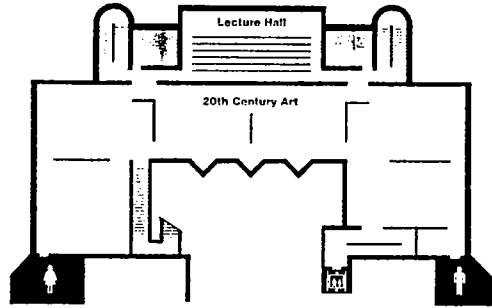

Mezzanine Level

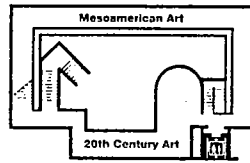

Main Level

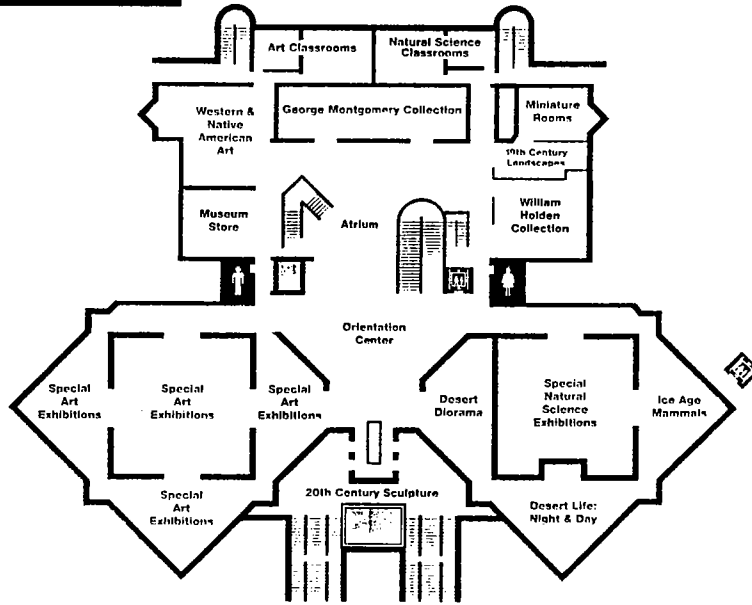

Theater/Lower Level

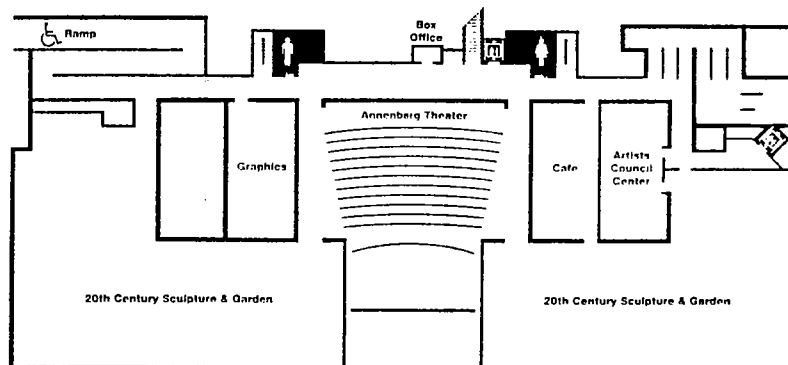

Nominee: E. STEWART WILLIAMS
Membership number: 008434656

Section 4: List of Reference Letters

1. Name JAMES R. CIOFFI, AIA
Address JAMES R. CIOFFI, ARCHITECT
2121 TAHQUITZ CANYON, SUITE 1
PALM SPRINGS, CA 92262
Telephone 760/325-1557
Title ARCHITECT
Professional relationship to nominee PRESIDENT, AIA CALIFORNIA DESERT
CHAPTER

2. Name CLINTON MARR, FAIA
Address 6816 HAWARDEN DRIVE
RIVERSIDE, CA 92506
Telephone 909/780-4578
Title ARCHITECT
Professional relationship to nominee FELLOW MEMBER OF AIA INLAND
CALIFORNIA CHAPTER

3. Name REUEL YOUNG, AIA
Address INTERACTIVE DESIGN GROUP
3001 E. TAHQUITZ CANYON, SUITE 104
PALM SPRINGS, CA 92262
Telephone 760/323-4990
Title ARCHITECT
Professional relationship to nominee IMMEDIATE PAST PRESIDENT,
AIA CALIFORNIA DESERT CHAPTER

Nominee: E. STEWART WILLIAMS
Membership number: 008434656

Section 4: List of Reference Letters

4. Name DANIEL K. THORNBURY, AIA
Address DANIEL K. THORNBURY, ARCHITECT
45120 SAN PABLO AVENUE, SUITE 2D
Telephone 760/779-8544
Title ARCHITECT
Professional relationship to nominee PRESIDENT-ELECT AIA CALIFORNIA
DESERT CHAPTER
5. Name ALBERT FREY, FAIA, EMERITUS
Address 686 PALISADES DRIVE
PALM SPRINGS, CA 92262
Telephone 760/325-2851
Title ARCHITECT
Professional relationship to nominee AIA CHAPTER MEMBER
JOINT VENTURE ARCHITECT
6. Name JANICE LYLE, Ph.D.
Address PALM SPRINGS DESERT MUSEUM
101 MUSEUM DRIVE
PALM SPRINGS, CA 92262
Telephone 760/325-7186
Title EXECUTIVE DIRECTOR/PALM SPRINGS DESERT MUSEUM
Professional relationship to nominee CLIENT
7. Name JULIUS SHULMAN
Address 7875 WOODROW WILSON DRIVE
LOS ANGELES, CA 90046
Telephone 213/654-0877
Title PHOTOGRAPHER
Professional relationship to nominee PHOTOGRAPHER
HONORARY AIA EMERITUS
MEMBER NO. 020509881